

1. EXISTING SITE IMPROVEMENTS DISTURBED OUTSIDE THE DESIGNATED CONSTRUCTION AREAS ARE TO BE REPLACED WITH EQUIVALENT CONSTRUCTION AT THE EXPENSE OF THE CONTRACTOR. EVERY EFFORT SHALL BE MADE TO MINIMIZE SUCH DISTURBANCES. THE CONTRACTOR SHALL TAKE ALL PRECAUTIONS NECESSARY TO AVOID DAMAGE TO EXISTING CONSTRUCTION AND UTILITIES TO REMAIN AND SHALL REPAIR DAMAGE CAUSED BY THE WORK AT NO ADDITIONAL COST TO THE OWNER.
2. IT SHALL BE THE RESPONSIBILITY OF THE CONTRACTOR TO MAINTAIN DRAINAGE FLOWS AT ALL TIMES DURING THE PERFORMANCE OF THE WORK. DAMAGE RESULTING FROM IMPROPER MAINTENANCE OF DRAINAGE SHALL BE IMMEDIATELY REPAIRED BY THE CONTRACTOR AT NO ADDITIONAL COST TO THE OWNER. COST OF MAINTAINING FLOWS IS INCIDENTAL TO THE CONTRACT.
3. THE CONTRACTOR SHALL TAKE NOTE OF ALL EXISTING CONDITIONS AND BE PREPARED TO MOVE OR DISPOSE OF OBJECTS OR MATERIALS WITHIN THE LIMITS OF THE PROJECT. SUCH WORK SHALL NOT BE CAUSE FOR ADDITIONAL COMPENSATION FOR A CHANGE IN THE SCOPE.
4. THE CONTRACTOR SHALL FIELD VERIFY ALL EXISTING AND NEW DIMENSIONS WITH FIELD CONDITIONS PRIOR TO BIDDING, FABRICATION AND CONSTRUCTION AND MAKE MINOR ADJUSTMENTS AS NECESSARY AND NOTIFY THE ENGINEER OF ANY CONDITIONS THAT MAY AFFECT THE OUTCOME OF THE WORK.
5. CONTRACTOR SHALL COORDINATE ALL WORK WITH THE OWNER, ENGINEER, AND OTHER TRADES THROUGHOUT THE PROJECT.
6. CONTRACTOR SHALL PROVIDE TRAFFIC CONTROL AND SIGNAGE IN ACCORDANCE WITH CONSTRUCTION STANDARDS AND SPECIFICATIONS OF ALL LOCAL GOVERNING AGENCIES, THE NATIONAL MANUAL ON UNIFORM TRAFFIC CONTROL DEVICES (MUTCD) AND IDOT SUPPLEMENT TO THE NATIONAL MUTCD AS DETERMINED BY THE ENGINEER. ACCESS TO PROPERTIES AND ENTRANCES SHALL BE PROVIDED BY THE CONTRACTOR AT ALL TIMES AND COORDINATED WITH THE OWNER, INCLUDING ANY INTERRUPTION OF ACCESS TO THE SITE.
7. THE CONTRACTOR IS RESPONSIBLE FOR THE INSTALLATION PRIOR TO ANY WORK AND MAINTENANCE THROUGHOUT THE PROJECT OF ALL NECESSARY SEDIMENT AND EROSION CONTROL MEASURES AND MODEL BEST MANAGEMENT PRACTICES (BMP) FOR LAND DISTURBANCE. THE CONTRACTOR IS RESPONSIBLE FOR PREVENTING EROSION OF THE SOIL EXPOSED BY DISTURBANCE DUE TO HIS/HER OPERATIONS. THE CONTRACTOR SHALL CONSTRUCT SAID EROSION CONTROL MEASURES IN ACCORDANCE WITH ARTICLES 280.01 TO 280.05 OF THE IDOT STANDARD SPECIFICATIONS, PER IEPA STANDARDS AND SPECIFICATIONS, PROJECT SPECIFICATIONS AND AS DIRECTED ON THE PLANS. ADDITIONAL MEASURES MAY BE REQUIRED AS DIRECTED BY ALL LOCAL GOVERNING AGENCIES, IEPA, IDOT AND/OR ENGINEER. THE CONTRACTOR SHALL BE RESPONSIBLE FOR REMOVAL OF ALL EROSION CONTROL MEASURES AND REPAIR OF ANY ERODED AREAS AFTER THE PROJECT ACCEPTANCE AND VEGETATION IN ALL LAWN DISTURBED AREAS HAS BEEN ESTABLISHED. NO ADDITIONAL COMPENSATION IS ALLOWED FOR TEMPORARY EROSION CONTROL. TEMPORARY EROSION CONTROL MEASURES WILL BE USED TO CORRECT CONDITIONS THAT DEVELOPED DURING CONSTRUCTION THAT WERE UNFORESEEN DURING THE DESIGN STAGE OR, THAT ARE NEEDED TEMPORARILY TO CONTROL EROSION THAT DEVELOPS DURING NORMAL CONSTRUCTION PRACTICES.
8. ALL CONSTRUCTION AND MATERIALS USED SHALL CONFORM TO THE CONSTRUCTION STANDARDS AND SPECIFICATIONS OF ALL LOCAL GOVERNING AGENCIES, GRANITE CITY HOUSING AUTHORITY, IEPA, AWWA, ASTM, IDOT, THE NATIONAL MUTCD, AND THE CURRENT APPROVED "AMERICANS WITH DISABILITIES ACT ACCESSIBILITY GUIDELINES" (ADAAG).
9. NO WORK SHALL OCCUR ON THE SITE UNTIL ALL NECESSARY PERMITS ARE SECURED WITH ALL LOCAL GOVERNING AGENCIES. SEDIMENT AND EROSION CONTROL MEASURES SHALL BE INSTALLED AND FUNCTIONING BEFORE ANY PERMIT WILL BE ISSUED. PERMITS AND LICENSES NECESSARY FOR THE PROCESSION OF WORK SHALL BE SECURED AND PAID FOR BY THE CONTRACTOR.
10. ALL DISTURBED AREAS AND LAWN AREA, EXCLUDING PAVED AND BUILDING AREAS, SHALL BE GRADED, SEEDED, FERTILIZED, MULCHED AND STRAWED WITHIN 7 DAYS FROM THE COMPLETION OF GRADING OPERATIONS OR SUSPENSION OF WORK AS DIRECTED BY THE ENGINEER IN ACCORDANCE WITH SECTIONS 250 AND 251 OF THE IDOT STANDARD SPECIFICATIONS, IEPA STANDARDS AND SPECIFICATIONS, AND PROJECT SPECIFICATIONS. SEEDING SHALL BE CLASS 1 LAWN MIXTURE.
11. HOT MIX BITUMINOUS MATERIALS SHALL NOT BE PLACED ON EXISTING BITUMINOUS/CONCRETE SURFACES OR ON AGGREGATE BASES WITHOUT THE APPLICATION OF BITUMINOUS MATERIALS PRIME COAT.
12. ALL TEMPORARY AGGREGATE PLACED BY THE CONTRACTOR SHALL BE REMOVED, GRADED, SEEDED, FERTILIZED, MULCHED AND STRAWED AT THE COMPLETION OF THE CONTRACT AS DIRECTED BY THE ENGINEER.
13. STORE TOPSOIL ONSITE AT AN APPROVED LOCATION AS DIRECTED BY THE ENGINEER AND OWNER. EXCESS TOPSOIL SHALL BE REMOVED FROM THE SITE BY THE CONTRACTOR AS NECESSARY AT NO ADDITIONAL COST TO THE OWNER. ANY EXCAVATED MATERIAL THAT IS APPROVED TO BE STORED ON SITE SHALL BE TRANSPORTED TO THE STORAGE SITE BY THE CONTRACTOR AND SHALL BE PROTECTED AND STABILIZED BY SEEDING OR OTHER APPROVED METHODS TO PREVENT EROSION AND SEDIMENT RUNOFF.
14. ANY PROPERTY CORNERS OR OTHER PERMANENT SURVEY CONTROL MONUMENTS DISTURBED BY CONSTRUCTION SHALL BE VERIFIED AND/OR RESET AT THE CONCLUSION OF THE PROJECT CONSTRUCTION BY A PROFESSIONAL LAND SURVEYOR LICENSED IN THE STATE OF ILLINOIS AND EMPLOYED BY THE CONTRACTOR. WRITTEN VERIFICATION SHALL BE PROVIDED TO THE OWNER, THROUGH THE ENGINEER, THAT ALL SAID EXISTING PROPERTY CORNERS AND/OR PERMANENT SURVEY CONTROL MONUMENTS SHOWN IN THE CONSTRUCTION PLANS HAVE BEEN PROTECTED AND/OR RESET.
15. RIGHT-OF-WAYS, PROPERTY LINES AND TOPOGRAPHY SHOWN HEREON HAVE BEEN TAKEN FROM THE BEST AVAILABLE RECORDS AND MUST BE VERIFIED BY THE CONTRACTOR TO HIS OWN SATISFACTION.
16. THE CONTRACTOR WILL COORDINATE ANY INTERRUPTION OF BUILDING UNIT OWNERS ACCESS WITH THEIR BUILDING UNIT WITH THAT RESPECTIVE BUILDING UNIT OWNER PRIOR TO CONSTRUCTION AND INSTALLATION OF THE SANITARY SEWER LATERALS.
17. THE ACTUAL LOCATION OF THE SANITARY SEWER LATERALS CONNECTIONS WILL BE FIELD LOCATED BY CONTRACTOR AND COORDINATED WITH THE OWNER AND ENGINEER. CONTRACTOR TO FIELD LOCATE THE EXISTING SANITARY SEWER AND THE SANITARY SEWER LATERAL CONNECTIONS TO SAID EXISTING SANITARY SEWER.
18. PRESERVE EXISTING TREES, WOODLANDS AND UNDERSTORY IN AND OUTSIDE THE LIMITS OF CONSTRUCTION.
19. ANY REFERENCE TO AN IDOT STANDARD IN THESE PLANS SHALL BE INTERPRETED TO MEAN THE EDITION AS INDICATED BY THE SUB-NUMBER LISTED.
20. PRIOR TO THE START OF CONSTRUCTION, THE CONTRACTOR SHALL ARRANGE TO HAVE ALL UNDERGROUND UTILITIES INCLUDING WATER, GAS, ELECTRIC, STORM SEWER, TELEPHONE AND CABLE TV LOCATED AND SUITABLY MARKED. SHOULD A UTILITY BE IN CONFLICT WITH THE PROPOSED CONSTRUCTION, THE ENGINEER SHALL BE NOTIFIED AT ONCE. SHOULD A UTILITY BE LOCATED PARALLEL TO THE PROPOSED PIPELINE AND WITHIN THE MAXIMUM TRENCH WIDTH AS DEFINED IN THE STANDARD SPECIFICATIONS, OR IN DIRECT GRADE CONFLICT WITH THE GRADE OF THE PROPOSED PIPE, ARRANGEMENTS SHALL BE MADE FOR THE UTILITY TO BE PROTECTED, OR IF PROTECTION IS NOT FEASIBLE, TO ARRANGE FOR THE UTILITY TO BE RELOCATED. SHOULD THE PROPOSED ALIGNMENT BE ALTERED IN THE FIELD, THE CONTRACTOR SHALL BE PAID FOR THE QUANTITIES OF WORK PERFORMED IN ACCORDANCE WITH THESE SPECIFICATIONS AND NO ADDITIONAL PAYMENT SHALL BE MADE. SHOULD A UTILITY OUTSIDE OF THE TRENCH WIDTH AND NOT IN DIRECT CONFLICT BE ENCOUNTERED, THE CONTRACTOR SHALL PROTECT IT OR HAVE IT RELOCATED AT HIS/HER OWN EXPENSE. LIKEWISE OTHER LINES SHALL BE PROTECTED AT NO ADDITIONAL EXPENSE TO THE OWNER AND WITHOUT CLAIM BY THE CONTRACTOR FOR DELAYS DUE TO SERVICE LINES ENCOUNTERED.
21. NECESSARY PRECAUTIONS SHALL BE TAKEN BY THE CONTRACTOR TO PROTECT EXISTING SERVICES AND MAINS, AND ANY DAMAGE TO THEM DUE TO HIS NEGLIGENCE SHALL BE REPAIRED IMMEDIATELY AT THE CONTRACTORS EXPENSE.
22. THE CONTRACTOR SHALL NOTIFY ALL UTILITY COMPANIES SEVEN (7) DAYS BEFORE STARTING WORK SHOWN ON THESE DRAWINGS. SOME, BUT NOT ALL, OF THE UTILITIES OF THIS PROJECT CAN BE CONTACTED PRIOR TO CONSTRUCTION BY CALLING THE JOINT UTILITY LOCATION INFORMATION FOR EXCAVATORS (JULIE), PHONE (800) 892-0123.
23. AFTER THE TRENCH HAS BEEN BACKFILLED, THE GROUND WILL BE RETURNED TO EXISTING OR PROPOSED GRADE AND NO EXCESS EXCAVATED MATERIAL WILL BE SPREAD IN THIS AREA.
24. THE CONTRACTOR SHALL BE RESPONSIBLE FOR REPAIRING AND REPLACING EXISTING FENCES, DRIVEWAYS, SIDEWALKS, ETC. DAMAGED OR REMOVED DURING CONSTRUCTION. ALL DISTURBED AREAS SHALL BE RETURNED TO THEIR ORIGINAL CONDITION. ALL TREES SHALL BE PROTECTED BY THE CONTRACTOR.
25. THE CONTRACTOR HAS NO AUTHORITY TO PERMIT THE USE OF ANY PORTION OF THE SITE BY ANYONE EXCEPT FOR BUSINESS CONNECTED WITH THE CONSTRUCTION IN WHICH THIS CONTRACT IS CONCERNED.
26. THE CONTRACTOR SHALL PERFORM EXPLORATORY EXCAVATION FAR ENOUGH IN ADVANCE OF THE WORK TO LOCATE EXISTING UTILITIES AND OBSTRUCTIONS SO THAT CORRECTIONS IN PROPOSED PIPE GRADE AND ALIGNMENT CAN BE MADE WITHOUT REMOVING PIPE ALREADY INSTALLED AND IN PLACE. ANY CORRECTION REQUIRED TO PIPE OR FACILITIES ALREADY INSTALLED DUE TO THE CONTRACTOR'S FAILURE TO LOCATE EXISTING UTILITIES AND OBSTRUCTIONS SHALL BE REMOVED AND REINSTALLED AT NO ADDITIONAL CONTRACT COST.
27. SHORT TUNNELS MAY BE REQUIRED BY THE ENGINEER AT SOME LOCATIONS WHILE CONSTRUCTING THE PROPOSED PIPELINES IN ORDER TO SAVE OBSTRUCTIONS SUCH AS TREES OR EXISTING PIPES WHICH ARE IN THE TRENCH WIDTH. THE COST OF SHORT TUNNELS SHALL BE INCIDENTAL TO THE COST OF CONSTRUCTION.
28. ANY DAMAGE TO EXISTING ROAD SURFACES AND SIDEWALKS BY CONTRACTOR'S EQUIPMENT SHALL BE REPAIRED TO ORIGINAL CONDITION OR BETTER, AND THE REPAIR SHALL BE ACCEPTABLE TO THE CITY AND OWNER. COST OF SUCH REPAIR OUTSIDE OF TRENCH WIDTH PAY LIMITS SHALL BE INCIDENTAL TO THE COST OF CONSTRUCTION.
29. DURING CONSTRUCTION, THE CONTRACTOR SHALL NOT CAUSE SEWAGE TO BE DISCHARGED ON THE GROUND, IN WATERWAYS OR INTO THE GROUND, NOR SHALL HE/SHE CAUSE BACKUP OF SEWAGE INTO BUILDINGS. DIVERT SEWAGE BY PUMPING AND/OR PIPING AROUND ANY PORTIONS OF THE SEWAGE SYSTEM WHICH ARE TAKEN OUT OF SERVICE.
30. REMOVING AND RE-INSTALLING EXISTING FENCES AND MAILBOXES TO CONSTRUCT THIS PROJECT SHALL BE INCIDENTAL TO THE COST OF CONSTRUCTION.

1. CONTRACTOR SHALL NOTIFY THE OWNER AND ALL LOCAL GOVERNING AGENCIES, 48 HOURS PRIOR TO THE COMMENCEMENT OF ANY CONSTRUCTION WORK.
2. CONTRACTOR TO PROVIDE ADEQUATE OFF-STREET PARKING FOR CONSTRUCTION EMPLOYEES. PARKING ON NON-SURFACED AREAS IS PROHIBITED IN ORDER TO ELIMINATE THE CONDITION WHEREBY MUD FROM CONSTRUCTION AND EMPLOYEE VEHICLES IS TRACKED ONTO THE PAVEMENT CAUSING HAZARDOUS ROADWAY AND DRIVING CONDITIONS.
3. CONTRACTOR SHALL KEEP ALL PAVEMENT SURFACES CLEAR OF MUD AND DEBRIS. ALL PAVEMENT SURFACES USED FOR CONSTRUCTION ACCESS THERETO SHALL BE CLEANED THROUGHOUT THE DAY.
4. EROSION AND SILTATION CONTROL SHALL BE INSTALLED PRIOR TO ANY WORK AND BE MAINTAINED THROUGHOUT THE PROJECT TO PREVENT DAMAGE OF OFFSITE PROPERTIES UNTIL ACCEPTANCE OF THE WORK BY THE OWNER AND/OR CONTROLLING REGULATORY AGENCY. PAVEMENT SURFACE HAS BEEN INSTALLED AND ADEQUATE VEGETATIVE GROWTH IN ALL DISTURBED AREAS HAS BEEN ESTABLISHED AND INSURES NO FURTHER EROSION OF THE SOIL. ADDITIONAL SILTATION CONTROL MAY BE REQUIRED AS DEEMED NECESSARY BY ALL LOCAL GOVERNING AGENCIES, IEPA, IDOT, ENGINEER AND/OR OWNER.
5. WHERE NATURAL VEGETATION IS REMOVED DURING GRADING, VEGETATION SHALL BE REESTABLISHED IN SUCH A DENSITY AS TO PREVENT EROSION.
6. WHEN WORK OPERATIONS ARE COMPLETED OR SUSPENDED FOR MORE THAN 7 DAYS, ALL NECESSARY PRECAUTIONS SHALL BE TAKEN TO RETAIN SOIL MATERIALS ONSITE. PROTECTIVE MEASURES MAY BE REQUIRED BY ALL LOCAL GOVERNING AGENCIES, IEPA AND/OR IDOT SUCH AS PERMANENT SEEDING, PERIODIC WETTING, MULCHING, OR OTHER SUITABLE MEANS.
7. IF CUT AND FILL OPERATIONS OCCUR DURING A SEASON NOT FAVORABLE FOR IMMEDIATE ESTABLISHMENT OF PERMANENT GROUND COVER, A FAST GERMINATING ANNUAL SUCH AS RYE GRASSES OR SUDAN GRASSES SHALL BE UTILIZED TO RETARD EROSION, IF ADEQUATE STORMWATER DETENTION AND EROSION CONTROL DEVICES HAVE NOT BEEN ESTABLISHED.
8. ALL FINISHED GRADES (AREAS NOT TO BE DISTURBED BY FUTURE IMPROVEMENT) IN EXCESS OF 4:1 (H:V) SLOPES SHALL BE MULCHED BY CONSTRUCTING EROSION CONTROL BLANKET IN ACCORDANCE WITH SECTION 251 OF THE IDOT STANDARD SPECIFICATIONS AND IEPA STANDARDS AND SPECIFICATIONS. THE EROSION CONTROL BLANKET SHALL BE EXCelsior BLANKET.
9. NO EXCAVATION SHALL BE MADE SO CLOSE TO THE PROPERTY LINE AS TO ENDANGER ANY ADJOINING PROPERTY OR ANY PUBLIC OR PRIVATE STREET WITHOUT SUPPORTING AND PROTECTING SUCH PROPERTY OR PUBLIC OR PRIVATE STREET FROM SETTLING, CRACKING OR OTHER DAMAGE.
10. STORM WATER STRUCTURES, PIPES, OUTLETS AND CHANNELS SHALL BE PROTECTED BY SILT BARRIERS AND KEPT FREE OF WASTE AND SILT AT ALL TIMES PRIOR TO FINAL SURFACE STABILIZATION AND/OR PAVING. INTERIM STORM WATER DRAINAGE CONTROL IN THE FORM OF SILTATION CONTROL MEASURES IS REQUIRED.
11. SILTATION FENCES SHALL BE INSPECTED PERIODICALLY AND AFTER EVERY STORM EVENT FOR DAMAGE AND THE AMOUNT OF SEDIMENT THAT HAS ACCUMULATED. REMOVAL OF SEDIMENT WILL BE REQUIRED WHEN IT REACHES 1/2 THE HEIGHT OF THE SILTATION FENCE OR 12", WHICHEVER IS LESS.
12. STRAW BALES SHALL BE INSPECTED PERIODICALLY AND AFTER EVERY STORM EVENT FOR DAMAGE, DETERIORATION AND THE AMOUNT OF SEDIMENT THAT HAS ACCUMULATED. BALES THAT HAVE ROTTED OR FAILED SHALL BE REPLACED. REMOVAL OF SEDIMENT WILL BE REQUIRED WHEN IT REACHES 1/2 THE HEIGHT OF THE BALES OR 12", WHICHEVER IS LESS.
13. ALL TRASH AND DEBRIS ONSITE, EITHER EXISTING OR FROM CONSTRUCTION, MUST BE REMOVED AND PROPERLY DISPOSED OF OFFSITE. DEBRIS AND FOUNDATION MATERIAL FROM ANY EXISTING ONSITE BUILDING OR STRUCTURE THAT IS SCHEDULED TO BE REMOVED FOR THIS PROJECT MUST BE PROPERLY DISPOSED OF OFFSITE. EXCESS, SURPLUS, UNUSABLE, UNSTABLE AND/OR UNSUITABLE MATERIALS RESULTING FROM CONSTRUCTION OF THIS PROJECT, INCLUDING THOSE RESULTING FROM REMOVAL OF EXISTING SIDEWALKS, PAVEMENTS, BUILDINGS AND/OR STRUCTURES, SHALL BE PROPERLY DISPOSED OF BY THE CONTRACTOR AT HIS/HER OWN EXPENSE IN A LEGAL MANNER, OUTSIDE THE SUBJECT PROPERTY IN SUCH A MANNER THAT PUBLIC OR PRIVATE PROPERTY WILL NOT BE DAMAGED OR ENDANGERED. COORDINATE WITH THE OWNER.
14. ALL EXCAVATIONS, GRADING OR FILLING SHALL HAVE A FINISHED GRADE NOT TO EXCEED A 4:1 SLOPE (25%), UNLESS SPECIFICALLY APPROVED OTHERWISE.
15. CONTRACTOR TO REMOVE AND DISPOSE OF ALL VEGETATION AFFECTING CONSTRUCTION WITHIN THE CONSTRUCTION LIMITS SHOWN ON THE PLANS IN ACCORDANCE WITH IDOT AND IEPA STANDARDS AND SPECIFICATIONS, UNLESS OTHERWISE NOTED. ALL REMOVED VEGETATION SHALL BE DISPOSED OF WITHIN 7 DAYS OF REMOVAL.
16. THE REMOVAL OF ALL UNUSABLE, UNSTABLE AND/OR UNSUITABLE MATERIALS IN ALL CUT AND FILL AREAS AND THEIR REPLACEMENT WITH SATISFACTORY MATERIAL, WHERE REQUIRED, SHALL BE INCIDENTAL TO THE CONTRACT.
17. EXCESS EXCAVATED MATERIAL NOT TO BE USED BY THE OWNER SHALL BE REMOVED FROM THE SITE BY THE CONTRACTOR AND PROPERLY DISPOSED OF ON A SITE PROVIDED BY THE CONTRACTOR AT NO ADDITIONAL COST TO THE OWNER.
18. THE CONTRACTOR SHALL BE RESPONSIBLE FOR PROTECTING THE UTILITY PROPERTY FROM CONSTRUCTION OPERATIONS AS OUTLINED IN ARTICLE 107.31 OF THE IDOT STANDARD SPECIFICATION. THE J.U.L.I.E. NUMBER IS 800-892-0123. A MINIMUM OF FORTY-EIGHT HOURS ADVANCE NOTICE IS REQUIRED.
19. STONE FOR HEAVY STONE REVETMENT BLANKET SHALL BE SOUND, DURABLE AND FREE FROM CRACKS AND OTHER STRUCTURAL DEFECTS THAT WOULD CAUSE THE REVETMENT TO DETERIORATE. THE STONE SHALL NOT CONTAIN ANY SOAPSTONE, SHALE OR OTHER MATERIAL EASILY DISINTEGRATED. THE STONE BLANKET SHALL BE AT LEAST 24 INCHES IN THICKNESS PERPENDICULAR TO THE BOTTOM OF THE DRAINAGE DITCH/SWALE. STONE SHOULD BE BLOCKY IN SHAPE RATHER THAN ELONGATED, MORE NEARLY CIRCULAR IN SHAPE, "NESTED" TOGETHER TO PROVIDE MORE RESISTANT TO MOVEMENT. THE STONE SHALL BE PREDOMINANTLY ANGULAR IN SHAPE. APRON LINING MUST EXTEND INTO A STABLE CHANNEL. HEAVY STONE REVETMENT SHALL BE UNDERLAIN WITH A MIRAFI 140N FILTER FABRIC AND PLACED ON A PREPARED SUBGRADE. ALL ENDS OF FILTER FABRIC TO BE ANCHORED IN ACCORDANCE WITH MANUFACTURER'S RECOMMENDATIONS.
20. COHESIVE FILL UNDER BUILDINGS, STEPS, PAVED AREAS, UTILITY LINES AND TRENCH BACKFILLS SHALL BE COMPACTED TO A MINIMUM 95% OF MAXIMUM DRY DENSITY. WELL GRADED AGGREGATE FILL UNDER SLABS ON GRADE, PAVED AREAS, UTILITY LINES AND TRENCH BACKFILLS SHALL BE COMPACTED TO A MINIMUM 95% OF MAXIMUM DRY DENSITY. WELL GRADED AGGREGATE FILL UNDER NON-STRUCTURAL AREAS SHALL BE COMPACTED TO A MINIMUM 100% OF MAXIMUM DRY DENSITY. UNDER LAWN OR UNPAVED AREAS, COMPACT SOIL TO A MINIMUM 85% MAXIMUM DRY DENSITY. COMPACTION SHALL BE IN ACCORDANCE WITH ASTM D-698 WITH 6" MAXIMUM COMPACTED LIFTS, UNLESS OTHERWISE SPECIFIED. CONTRACTOR SHALL ADJUST AFOREMENTIONED COMPACTION INFORMATION BASED ON GEOTECHNICAL REPORT AND PROJECT SPECIFICATIONS IF SAID GEOTECHNICAL REPORT AND PROJECT SPECIFICATIONS DIFFERS FROM AFOREMENTIONED COMPACTION INFORMATION.

1. MAINTAIN SEPARATION OF WATERMAIN FROM SEWER PIPING IN ACCORDANCE WITH IEPA SECTION 653.119 PROTECTION OF WATER MAIN AND WATER SERVICE LINES. SECTION 370.350 OF THE ILLINOIS RECOMMENDED STANDARDS FOR SEWAGE WORKS, AND 653.111 OF THE ILLINOIS RECOMMENDED STANDARDS FOR WATER MAINS, AND THE ILLINOIS RECOMMENDED STANDARDS FOR SEWER MAINS, LATEST EDITIONS, SHALL APPLY. PARALLEL INSTALLATION WATER MAINS SHALL BE LAID AT LEAST TEN FEET HORIZONTALLY FROM ANY EXISTING OR PROPOSED DRAIN, STORM SEWER, SANITARY SEWER, COMBINED SEWER OR SEWER SERVICE CONNECTION. THE DISTANCE SHALL BE MEASURED EDGE TO EDGE. CROSSINGS - WATER MAINS SHALL BE LAID SO THAT ITS INVERT IS 18 INCHES ABOVE THE CROWN OF THE DRAIN OR SEWER. WHEREVER WATER MAINS CROSS STORM SEWERS, SANITARY SEWERS OR SEWER SERVICE CONNECTIONS, THE WATER MAIN SHALL BE MAINTAINED BELOW THE MAIN OF THE SEWER MAIN. THE MAIN SHALL BE LOCATED WITHIN 18 INCHES HORIZONTALLY OF ANY SEWER OR DRAIN CROSSED. A LENGTH OF WATER MAIN PIPE SHALL BE LOCATED OVER THE SEWER TO BE CROSSED WITH JOINTS EQUIDISTANT FROM THE SEWER OR DRAIN.

ANY UNDERGROUND FACILITIES, STRUCTURES, OR UTILITIES THAT HAVE BEEN PLOTTED AND SHOWN FROM AVAILABLE INFORMATION AND RECORDS. THEREFORE, THEIR LOCATION AND RELATIONSHIP TO NEW PROPOSED WORK MUST BE CONSIDERED APPROXIMATE ONLY. THE VERIFICATION OF THE LOCATION OF UNDERGROUND FACILITIES, STRUCTURES AND UTILITIES EITHER SHOWN OR NOT SHOWN ON THE PLANS, SHALL BE THE RESPONSIBILITY OF THE CONTRACTOR AND SHALL BE LOCATED PRIOR TO ANY WORK. IT IS THE CONTRACTOR'S RESPONSIBILITY TO NOTIFY ALL THE LOCAL GOVERNING AGENCIES AND UTILITY COMPANIES PRIOR TO CONSTRUCTION TO DETERMINE THEIR UNDERGROUND FACILITIES, STRUCTURES AND UTILITIES EXACT LOCATION AND THE EXISTENCE OF ANY NOT SHOWN. CONTRACTOR SHALL COORDINATE WITH UTILITY COMPANIES AND THE OWNER AS TO THE SELECTION OF THE RECORDS OF ALL UTILITIES SHOWN OR NOT SHOWN. THE ENGINEER/ARCHITECT AND THE OWNER DO NOT WARRANT OR GUARANTEE THE COMPLETENESS OR THE CORRECTNESS OF THE INFORMATION GIVEN.

AC	ACRES	N	NORTHING
APPROX	APPROXIMATE	NTS	NOT TO SCALE
ASB	ABOVEGROUND SPLICE BOX	OC	ON CENTER
BOP	BEGINNING OF PROJECT	PC	POINT OF CURVATURE
CFS	CUBIC FEET PER SECOND	PL	PROPERTY LINE
CI	CURB INLET	PROP	PROPOSED
CJ	CONTROL JOINT	PSI	POUNDS PER SQUARE INCH
CL	CENTERLINE	PT	POINT OF TANGENCY
CLR	CLEAR	PVC	POLYVINYL CHLORIDE PIPE
CMP	CORRUGATED METAL PIPE	Q	DISCHARGE
CO	CLEANOUT	R	RADIUS
CONC	CONCRETE	RCP	REINFORCED CONCRETE PIPE
E	EASTING	REINF	REINFORCED
E	VERTICAL CURVE EXTERNAL DISTANCE	RJ	RESTRAINED JOINT
EJ	EXPANSION JOINT	ROW	RIGHT-OF-WAY
ELV	ELEVATION	STA	STATION
END	END OF PROJECT	T	TOP
EX	EXISTING	TBA	TO BE ADJUSTED
FES	FLARED END SECTION	TBR	TO BE REMOVED
FL	FLOWLINE	TO	TO OF
FO	FIBER OPTIC CABLE	TYP	TYPICAL
G	GAS MAIN	UGE	UNDERGROUND ELECTRIC
HC	HANDICAP	UIP	USE IN PLACE
HDPE	HIGH DENSITY POLYETHYLENE	VPC	VERTICAL POINT OF CURVATURE
HGL	HYDRAULIC GRADE LINE	VPT	VERTICAL POINT OF INTERSECTION
HP	HIGH POINT	VPI	VERTICAL POINT OF TANGENCY
HYD	FIRE HYDRANT	W	WATER MAIN
K	RATE OF CURVATURE	W/	WITH
LB	POUNDS	WV	WATER VALVE
LF	LINEAL FEET	WWF	WELDED WIRE FABRIC
LP	LOW POINT	ø	DIAMETER
MIN	MINIMUM	⊗	AT
MH	MANHOLE	±	PLUS OR MINUS

1. ALL SANITARY SEWER IMPROVEMENTS AND APPURTENANCES METHOD OF CONSTRUCTION AND MATERIALS SHALL CONFORM TO THE STANDARD SPECIFICATIONS FOR WATER AND SEWER MAIN CONSTRUCTION IN ILLINOIS AND THE CONSTRUCTION STANDARDS AND SPECIFICATIONS OF ALL LOCAL GOVERNING AGENCIES GRANITE CITY HOUSING AUTHORITY, IEPA, ASTM, IDOT, ILLINOIS POLLUTION CONTROL BOARD, ILLINOIS STATE PLUMBING CODE, STANDARD SPECIFICATIONS FOR WATER AND SEWER MAIN CONSTRUCTION IN ILLINOIS AND GREAT LAKES - UPPER MISSISSIPPI RIVER BOARD TO STATES STANDARDS.
2. PRIOR TO OBTAINING CONSTRUCTION PERMITS THE CONTRACTOR SHALL BE REQUIRED TO PROVIDE THE JURISDICTIONAL ENTITIES WITH A COPY OF AN EXECUTED CERTIFICATE OF INSURANCE INDICATING THAT THE PERMITEE HAS OBTAINED AND WILL CONTINUE TO CARRY COMMERCIAL GENERAL LIABILITY AND COMPREHENSIVE AUTO LIABILITY INSURANCE.
3. UNDERGROUND FACILITIES, STRUCTURES AND UTILITIES HAVE BEEN PLOTTED AND SHOWN FROM AVAILABLE INFORMATION AND RECORDS. THEREFORE, THEIR LOCATION AND RELATIONSHIP TO NEW PROPOSED WORK MUST BE CONSIDERED APPROXIMATE ONLY. THE VERIFICATION OF THE LOCATION OF UNDERGROUND FACILITIES, STRUCTURES AND UTILITIES, EITHER SHOWN OR NOT SHOWN ON THESE PLANS, SHALL BE THE RESPONSIBILITY OF THE CONTRACTOR AND SHALL BE LOCATED PRIOR TO ANY WORK. IT IS THE CONTRACTOR'S RESPONSIBILITY TO NOTIFY ALL LOCAL GOVERNING AGENCIES AND UTILITY COMPANIES PRIOR TO ANY CONSTRUCTION TO DETERMINE THEIR UNDERGROUND FACILITIES, STRUCTURES AND UTILITIES EXACT LOCATION AND THE EXISTENCE OF ANY NOT SHOWN. CONTRACTOR SHALL COORDINATE WITH UTILITY COMPANIES AND THE OWNER AS TO THE RELOCATION OR REMOVAL OF ANY UTILITIES SHOWN OR NOT SHOWN. THE ENGINEER AND THE OWNER DO NOT WARRANT OR GUARANTEE THE COMPLETENESS OR THE CORRECTNESS OF THE INFORMATION GIVEN.
4. CONTRACTOR TO CLEAN AND TELEVIEW THE EXISTING SANITARY SEWER MAIN AS NECESSARY TO DETERMINE THE LOCATION OF THE EXISTING SANITARY SEWER LATERALS. ACCESS TO THE EXISTING SANITARY SEWER MAIN SYSTEM SHALL BE COORDINATED WITH ILLINOIS AMERICAN WATER COMPANY. THEN CONTRACTOR TO REMOVE AND REPLACE EXISTING SANITARY SEWER LATERALS AND PROVIDE NEW SANITARY SEWER CLEANOUTS AS SHOWN ON THE PROPOSED SITE PLANS AND PURSUANT TO PROJECT DETAILS. 6 UNIT BUILDINGS HAVE 3 SANITARY SEWER LATERAL REPLACEMENTS, AND 4 UNIT BUILDINGS HAVE 2 SANITARY SEWER LATERALS REPLACEMENTS.
5. ALL SANITARY SEWER LATERALS SHALL BE THE SAME DIAMETER AS THE EXISTING SANITARY SEWER LATERALS. SANITARY SEWER LATERALS SHALL BE JOINTS PER ASTM D-3034, F-1336, AND D-1784 WITH MINIMUM CELL CLASSIFICATION OF 12454. PVC PER ASTM D-3212, PUSH-ON CASSETS PER ASTM F-477, MINIMUM WALL THICKNESS SDP-26. SANITARY SEWER LATERALS CAN ALSO BE PVC PER ASTM D-1785, SCHEDULE 80 WITH BELL AND SPIGOT STYLE SOLVENT SEALED JOINTS ENDS. JOINTS PER ASTM D-2855 SOLVENT WELD WITH ASTM D-2564 SOLVENT CEMENT. FITTINGS SHALL BE PVC CONFORMING TO ASTM D-2466. INSTALLATION PER ASTM D-2321. DEPTH TO MATCH THE EXISTING SANITARY SEWER LATERALS DEPTH. CLEANOUTS SHALL BE INSTALLED AT ALL ALIGNMENT CHANGES PURSUANT TO PROJECT DETAILS.
6. CONTRACTOR SHALL VERIFY DEPTH OF EXISTING SEWERS PRIOR TO ORDERING OR INSTALLING NEW SEWERS.
7. CARE OF FLOW IS THE RESPONSIBILITY OF THE CONTRACTOR.
8. CONTRACTOR TO VERIFY EXISTING SANITARY SEWER LATERAL LOCATIONS AND MAKE FIELD ADJUSTMENTS AS NECESSARY.
9. GRANULAR CRADLE SHALL BE CONSTRUCTED ON ALL PVC SANITARY SEWER PIPING FROM A PLANE 6" BELOW THE PIPE TO A PLANE 6" ABOVE THE PIPE. GRANULAR CRADLE SHALL CONSIST OF CLASS II EMBEDMENT MATERIAL AS PER ASTM D-2321 AND SHALL CONFORM TO IDOT GRADATIONS FA-10, FA-6, OR CA-6. SELECT GRANULAR BACKFILL SHALL CONFORM TO IDOT GRADATION CA-7.
10. UTILITY LOCATIONS AND ELEVATIONS ARE APPROXIMATE. IT IS THE CONTRACTOR RESPONSIBILITY TO FIELD VERIFY ALL UTILITIES.
11. ALL TRENCHES UNDER AREAS TO BE PAVED AND UNDER EXISTING PAVING SHALL BE FULL HEIGHT GRANULARLY FILLED WITH COMPACTED SELECT GRANULAR BACKFILL. BACKFILL SHALL BE PLACED IN ACCORDANCE WITH THE CONSTRUCTION STANDARDS AND SPECIFICATIONS OF IEPA AND IDOT, PROJECT SPECIFICATIONS AND AS DIRECTED ON THE PLANS.
12. THE CONTRACTOR IS RESPONSIBLE FOR ALL OSHA SAFETY COMPLIANCES WHEN TRENCHING AND LAYING UTILITIES.
13. EXISTING ABOVE AND BELOW GROUND UTILITIES TO BE PROTECTED AND USED IN PLACE, UNLESS OTHERWISE SPECIFIED. EXISTING UTILITIES AND/OR STRUCTURES AFFECTED BY CONSTRUCTION, EITHER SHOWN OR NOT SHOWN ON THE PLANS, SHALL BE ADJUSTED TO GRADE.
14. ABANDONED UNDERGROUND UTILITIES THAT CONFLICT WITH CONSTRUCTION SHALL BE DISPOSED OUTSIDE THE LIMITS OF CONSTRUCTION ACCORDING TO ARTICLE 202.03 OF THE IDOT STANDARD SPECIFICATIONS AND AS DIRECTED BY THE ENGINEER. THIS WORK WILL NOT BE PAID FOR SEPARATELY, BUT SHALL BE CONSIDERED INCIDENTAL TO THE CONTRACT.
15. CONTRACTOR WILL COORDINATE ANY INTERRUPTION OF ANY SERVICE LINE WITH THE LOCAL GOVERNING UTILITY AGENCIES AND THE OWNER TO LIMIT UTILITY OUTAGE TO EXISTING CUSTOMERS. THE ACTUAL LOCATION OF THE POINT OF CONNECTION IS APPROXIMATE AND SHALL BE FIELD LOCATED BY THE CONTRACTOR.
16. CONTRACTOR TO INSTALL ALL UTILITIES AND APPURTENANCES AS REQUIRED AND IN ACCORDANCE WITH ALL LOCAL GOVERNING UTILITY AGENCIES, MUNICIPALITIES AND STATE AND FEDERAL REQUIREMENTS, INCLUDING, BUT NOT LIMITED TO SANITARY SEWER PIPING, SERVICE LATERALS, SERVICE CONNECTIONS, CLEANOUTS, FITTINGS, PIPE BEDDING, ETC.
17. CONTRACTOR TO LOCATE EXISTING EASEMENT AND/OR RIGHT-OF-WAY LINES AND INSTALL PROPOSED UTILITY IMPROVEMENTS, SANITARY SEWER PIPING, SERVICE LATERALS, SERVICE CONNECTION, CLEANOUTS, FITTINGS, AND APPURTENANCES WITHIN THE EXISTING EASEMENT AND/OR RIGHT-OF-WAY LIMITS AND/OR ON GRANITE CITY HOUSING AUTHORITY PROPERTY AS SHOWN ON PLANS.
18. THE CONTRACTOR SHALL LIMIT THE AMOUNT OF TRENCH TO BE OPEN AT ANY GIVEN TIME TO A MAXIMUM OF FORTY (40) LINEAR FEET AS MEASURED ALONG THE CENTERLINE OF THE PROPOSED PIPING. ALL OPEN TRENCHES SHALL BE BACKFILLED AT THE END OF EACH DAY'S WORK AND IMMEDIATE MEASURES TAKEN TO STABILIZE THE DISTURBED AREA.

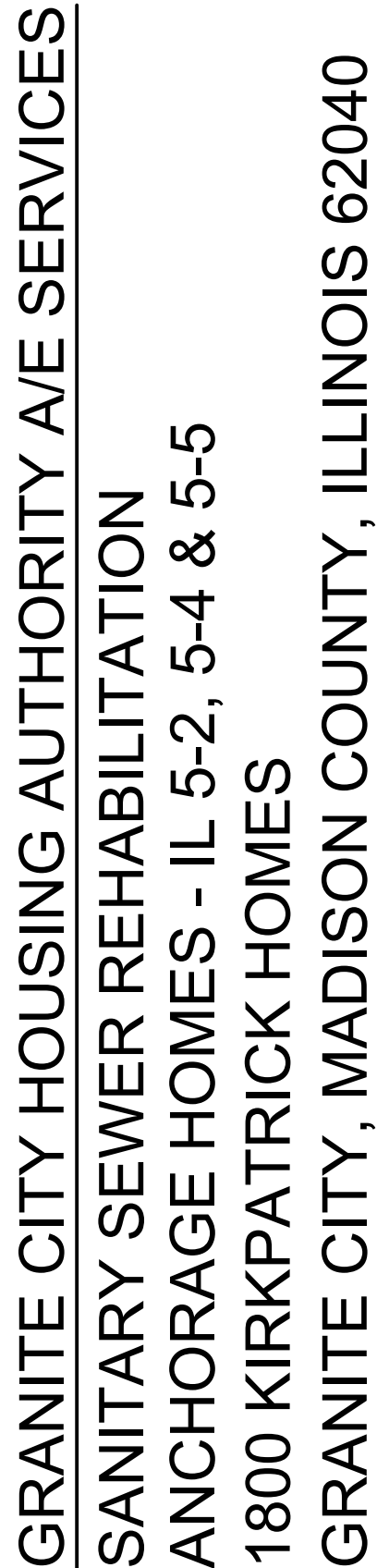

NOTES AND ABBREVIATIONS

C-001

GENERAL NOTES:

1. CONTRACTOR TO CLEAN AND TELEVIEW THE EXISTING SANITARY SEWER MAIN AS NECESSARY TO DETERMINE THE LOCATION OF THE EXISTING SANITARY SEWER LATERALS. ACCESS TO THE EXISTING SANITARY SEWER MAIN SYSTEM SHALL BE COORDINATED WITH ILLINOIS AMERICAN WATER COMPANY. THEN CONTRACTOR TO REMOVE AND REPLACE EXISTING SANITARY SEWER LATERALS WITH 12" DIA. PVC PER ASTM D-3034, F-1536, AND D-1784 WITH MINIMUM CELL CLASSIFICATION OF 12454. JOINTS PER ASTM D-3212, PUSH-ON GASKETS PER ASTM F-477, MINIMUM WALL THICKNESS SDR-26. SANITARY SEWER LATERALS CAN ALSO BE PVC PER ASTM D-1785, SCHEDULE 80 WITH BELL AND SPIGOT STYLE SOLVENT SEALED JOINTS PER ASTM D-3212, PUSH-ON GASKETS PER ASTM F-477, MINIMUM WALL THICKNESS SDR-26. FITTERS SHALL BE PVC CONFORMING TO ASTM D-2466. INSTALLATION PER ASTM D-2321. DEPTH TO MATCH THE EXISTING SANITARY SEWER LATERALS DEPTH. CLEANSOUTS SHALL BE INSTALLED AT ALL ALIGNMENT CHANGES PURSUANT TO PROJECT DETAILS.
2. VERIFY DEPTH OF EXISTING SANITARY SEWER LATERALS. VERIFY DEPTH OF EXISTING SANITARY SEWER LATERALS. CARE OF FLOW IS THE RESPONSIBILITY OF THE CONTRACTOR.
3. CONTRACTOR TO VERIFY EXISTING SANITARY SEWER LATERAL LOCATIONS AND MAKE FIELD ADJUSTMENTS AS NECESSARY.
4. ALL EXISTING TREES SHALL BE PROTECTED, AND THERE IS NO TREE REMOVED INCLUDED AS PART OF THIS PROJECT.
5. ALL EXISTING CONCRETE SIDEWALKS SHALL BE REMOVED AND REPLACED IN KIND AS NECESSARY TO COMPLETE THE PROPOSED SANITARY SEWER LATERAL REPLACEMENTS, AND ANY EXISTING CONCRETE SIDEWALKS DAMAGED DURING CONSTRUCTION SHALL BE REMOVED AND REPLACE IN KIND.
6. ALL EXISTING CONCERNANCES METHOD OF CONSTRUCTION AND MATERIALS SHALL CONFORM TO THE STANDARD SPECIFICATIONS FOR WATER AND SEWER MAIN CONSTRUCTION IN ILLINOIS AND THE CONSTRUCTION STANDARDS AND SPECIFICATIONS OF ALL LOCAL GOVERNING AGENCIES, GRANITE CITY HOUSING AUTHORITY, IEPA, ASTM, AND IAD.
7. HORIZONTAL AND VERTICAL SPECIFICATIONS FOR SANITARY SEWER OR SANITARY SERVICES, AND WATER OR WATER MAINS SHALL BE SHOWN ON SHEET 170.0. ALL WORK SHALL BE IN ACCORDANCE WITH THE STANDARD SPECIFICATIONS OR SECTION 411-2.01 OF THE STANDARD SPECIFICATION FOR WATER AND SEWER MAIN CONSTRUCTION IN ILLINOIS, LATEST EDITION.
10. CONTRACTOR WILL COORDINATE ANY INTERRUPTION OF ANY SERVICE LINE WITH CITY AND CUSTOMER TO LIMIT OUTAGE TO THE CUSTOMERS.
11. THE CONTRACTOR WILL COORDINATE ANY INTERRUPTION OF BUILDING UTILITY OWNERS ACCESS WITH THEIR BUILDING UTILITY OWNERS RESPECTIVE BUILDING UTILITY OWNERS. PRICE OF ANY INTERRUPTIONS SHALL BE THE RESPONSIBILITY OF THE CONTRACTOR.
12. UTILITY LOCATIONS AND ELEVATIONS ARE APPROXIMATE. IT IS THE CONTRACTOR RESPONSIBILITY TO FIELD VERIFY ALL UTILITIES.
13. ALL TRENCHES UNDER AREAS TO BE PAVED AND UNDER EXISTING PAVING SHALL BE FULL HEIGHT GRANULARLY FILLED WITH FULL DEPTH SELLER QUALITY CRUSHED GRANULAR TOPSOIL. THE SURFACE SHALL BE RESTORED WITH FULL DEPTH PAVEMENT REPLACEMENT TO MATCH EXISTING PAVEMENT SECTION/THICKNESS. BACKFILL AND PAVEMENT SHALL BE PLACED IN ACCORDANCE WITH THE CONSTRUCTION STANDARDS AND SPECIFICATIONS OF ALL LOCAL GOVERNING AGENCIES SPECIFICATIONS AND AS DIRECTED ON THE PLANS.
14. EXISTING UTILITIES ABOVE GROUND SHALL BE PROTECTED AND USED IN PLACE, UNLESS OTHERWISE SPECIFIED. EXISTING UTILITIES AND/OR STRUCTURES AFFECTED BY CONSTRUCTION, EITHER SHOWN OR NOT SHOWN ON THE PLANS, SHALL BE ADJUSTED TO GRADE.
15. ABANDONED UNDERGROUND UTILITIES THAT CONFLICT WITH CONSTRUCTION SHALL BE DISPOSED OF OUTSIDE THE LIMITS OF THE CONSTRUCTION ZONE AS DIRECTED BY THE ENGINEER. THIS WORK WILL NOT BE PAID FOR SEPARATELY, BUT SHALL BE CONSIDERED INCIDENTAL TO THE CONTRACT.

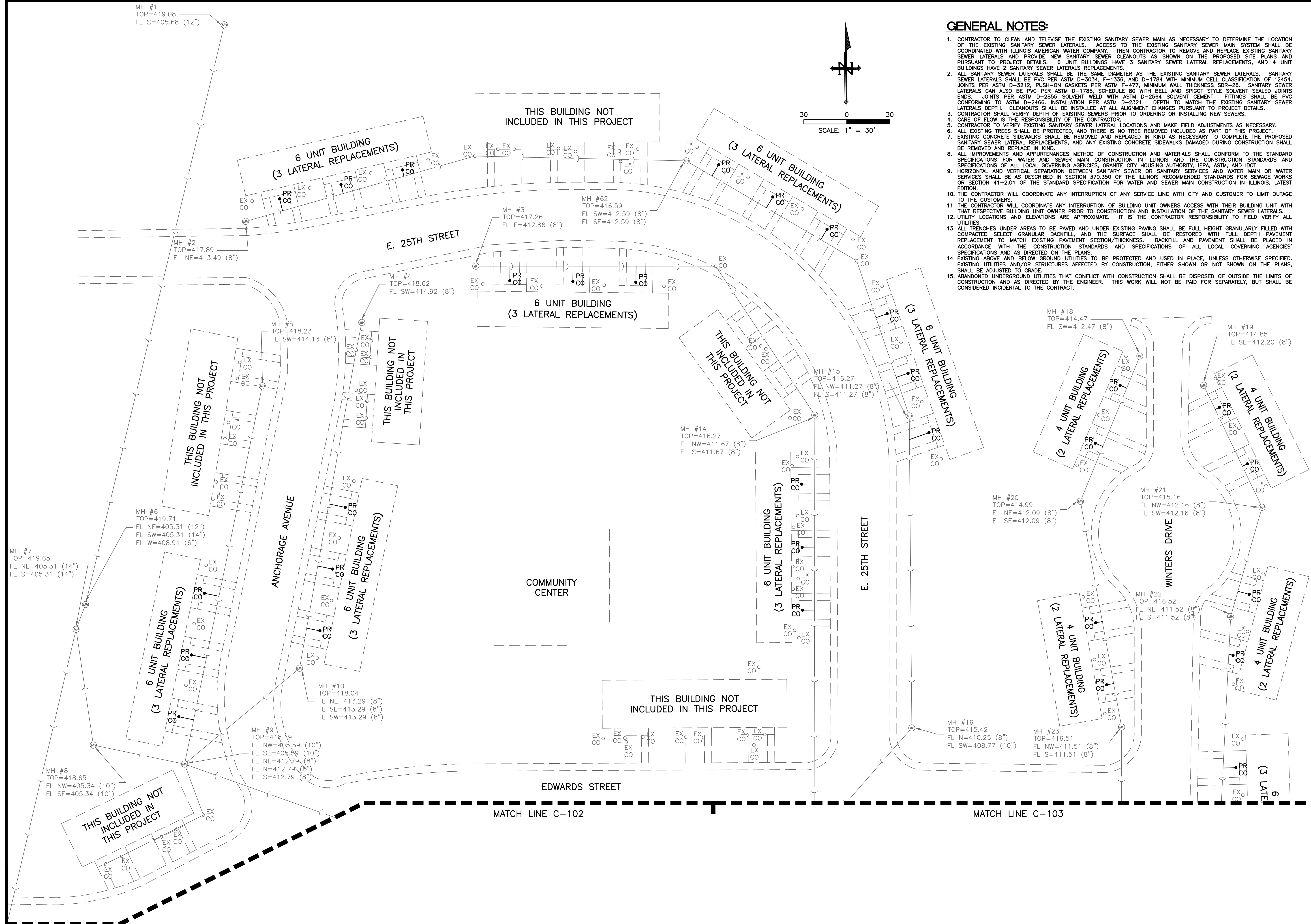
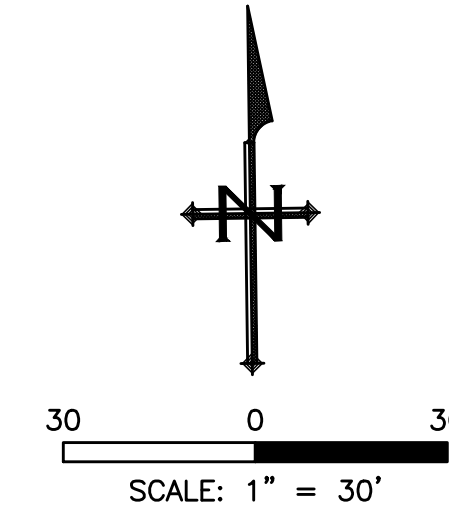

GRANITE CITY HOUSING AUTHORITY A/E SERVICES
SANITARY SEWER REHABILITATION
ANCHORAGE HOMES - IL 5-2, 5-4 & 5-5
1800 KIRKPATRICK HOMES
GRANITE CITY, MADISON COUNTY, ILLINOIS 62040

MK.	DATE	DESCRIPTION
DATE: 03-13-2024		
PROJECT NO: 280-0454		
DESIGN: ZAY	DRAWN: JMA	CHECK: SMS

SITE PLAN

C-101

GRANITE CITY HOUSING AUTHORITY A/E SERVICES
SANITARY SEWER REHABILITATION
ANCHORAGE HOMES - IL 5-2, 5-4 & 5-5
1800 KIRKPATRICK HOMES
GRANITE CITY, MADISON COUNTY, ILLINOIS 62040

NO.	DATE	DESCRIPTION
DATE: 03-13-2024		
PROJECT NO: 280-0454		
DESIGN:	DRAWN:	CHECK:
ZAY	JMA	SMS

SITE PLAN

C-102

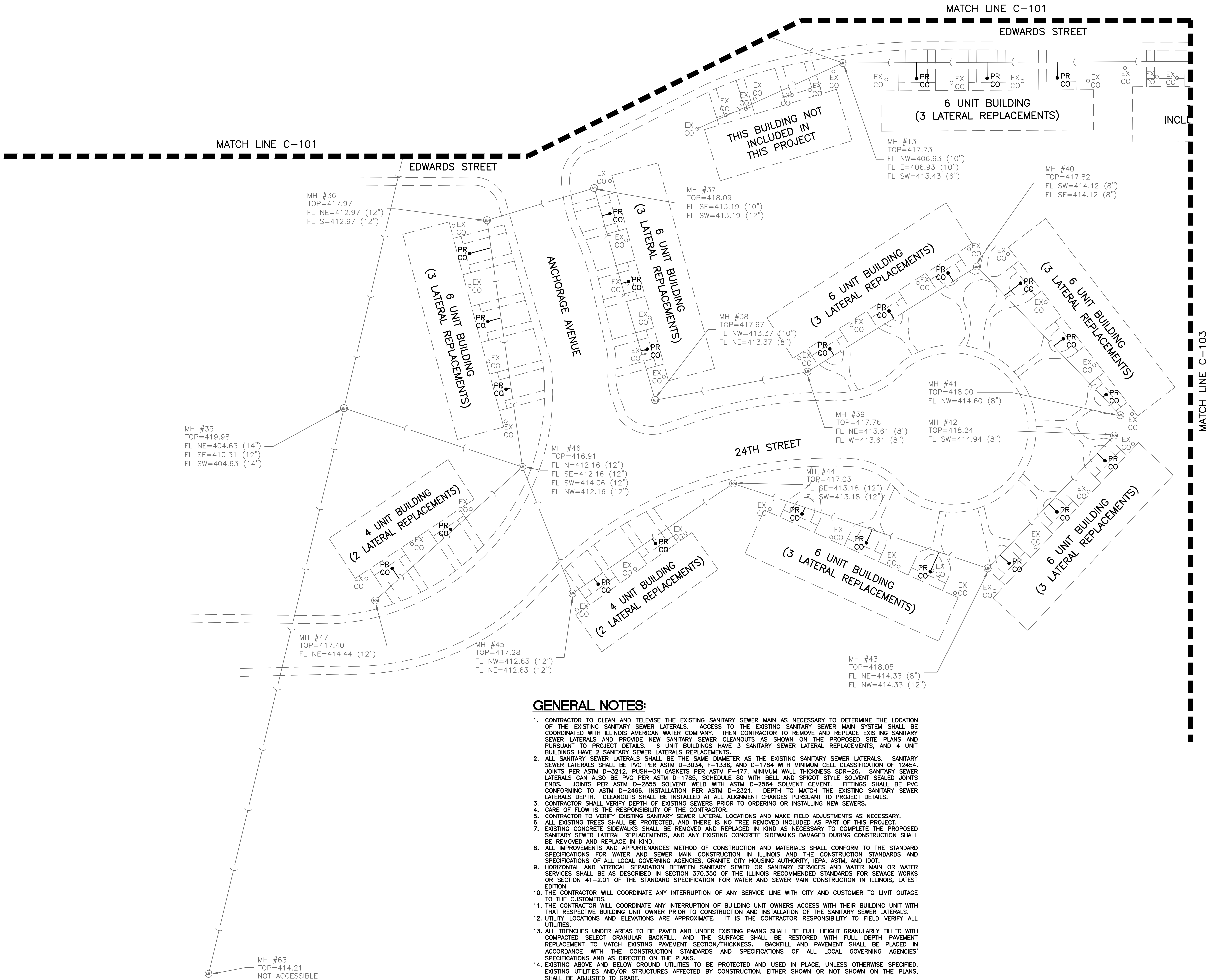

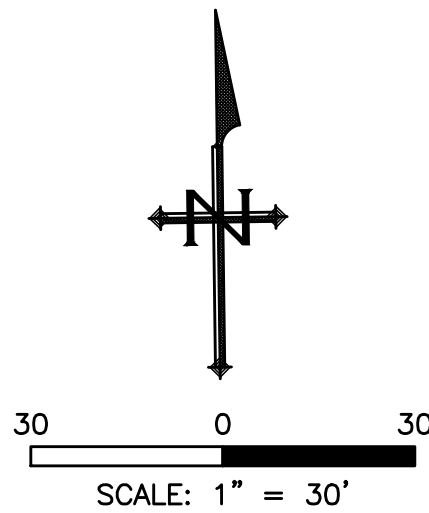
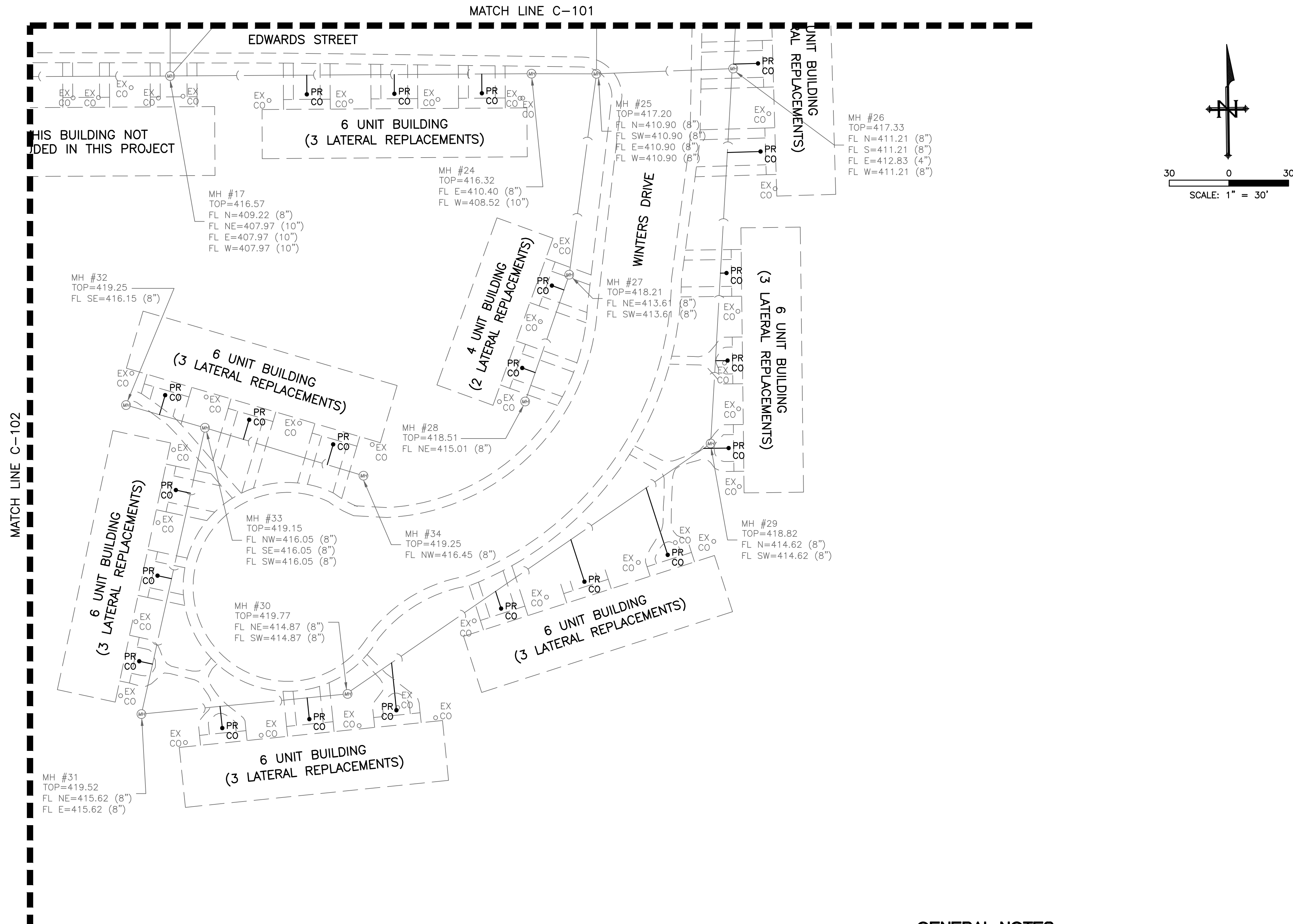

GRANITE CITY HOUSING AUTHORITY A/E SERVICES
SANITARY SEWER REHABILITATION
ANCHORAGE HOMES - IL 5-2, 5-4 & 5-5
1800 KIRKPATRICK HOMES
GRANITE CITY, MADISON COUNTY, ILLINOIS 62040

GENERAL NOTES:

- CONTRACTOR TO CLEAN AND TELEVIEW THE EXISTING SANITARY SEWER MAIN AS NECESSARY TO DETERMINE THE LOCATION OF THE EXISTING SANITARY SEWER LATERALS. ACCESS TO THE EXISTING SANITARY SEWER MAIN SYSTEM SHALL BE COORDINATED WITH ILLINOIS AMERICAN WATER COMPANY. THEN CONTRACTOR TO REMOVE AND REPLACE EXISTING SANITARY SEWER LATERALS AND PROVIDE NEW SANITARY SEWER CLEANOUTS AS SHOWN ON THE PROPOSED SITE PLANS AND PURSUANT TO PROJECT DETAILS. 6 UNIT BUILDINGS HAVE 3 SANITARY SEWER LATERAL REPLACEMENTS, AND 4 UNIT BUILDINGS HAVE 2 SANITARY SEWER LATERALS REPLACEMENTS.
- ALL SANITARY SEWER LATERALS SHALL BE THE SAME DIAMETER AS THE EXISTING SANITARY SEWER LATERALS. SANITARY SEWER LATERALS SHALL BE PVC PER ASTM D-3034, F-1336, AND D-1784 WITH MINIMUM CELL CLASSIFICATION OF 12454. JOINTS PER ASTM D-3212, PUSH-ON GASKETS PER ASTM F-477, MINIMUM WALL THICKNESS SDR-26. SANITARY SEWER LATERALS CAN ALSO BE PVC PER ASTM D-1785, SCHEDULE 80 WITH BELL AND SPIGOT STYLE SOLVENT SEALED JOINTS. ENDS. JOINTS PER ASTM D-2855 SOLVENT WELD WITH ASTM D-2564 SOLVENT CEMENT. FITTINGS SHALL BE PVC CONFORMING TO ASTM D-2466, INSTALLATION PER ASTM D-2321. DEPTH TO MATCH THE EXISTING SANITARY SEWER LATERALS DEPTH. CLEANOUTS SHALL BE INSTALLED AT ALL ALIGNMENT CHANGES PURSUANT TO PROJECT DETAILS.
- CONTRACTOR SHALL VERIFY DEPTH OF EXISTING SEWERS PRIOR TO ORDERING OR INSTALLING NEW SEWERS.
- CARE OF FLOW IS THE RESPONSIBILITY OF THE CONTRACTOR.
- CONTRACTOR TO VERIFY EXISTING SANITARY SEWER LATERAL LOCATIONS AND MAKE FIELD ADJUSTMENTS AS NECESSARY.
- ALL EXISTING TREES SHALL BE PROTECTED, AND THERE IS NO TREE REMOVED INCLUDED AS PART OF THIS PROJECT.
- EXISTING CONCRETE SIDEWALKS SHALL BE REMOVED AND REPLACED IN KIND AS NECESSARY TO COMPLETE THE PROPOSED SANITARY SEWER LATERAL REPLACEMENTS, AND ANY EXISTING CONCRETE SIDEWALKS DAMAGED DURING CONSTRUCTION SHALL BE REMOVED AND REPLACE IN KIND.
- ALL IMPROVEMENTS AND APPURTENANCES METHOD OF CONSTRUCTION AND MATERIALS SHALL CONFORM TO THE STANDARD SPECIFICATIONS FOR WATER AND SEWER MAIN CONSTRUCTION IN ILLINOIS AND THE CONSTRUCTION STANDARDS AND SPECIFICATIONS OF ALL LOCAL GOVERNING AGENCIES, GRANITE CITY HOUSING AUTHORITY, IEPA, ASTM, AND IDOT.
- HORIZONTAL AND VERTICAL SEPARATION BETWEEN SANITARY SEWER OR SANITARY SERVICES AND WATER MAIN OR WATER SERVICES SHALL BE AS DESCRIBED IN SECTION 370.350 OF THE ILLINOIS RECOMMENDED STANDARDS FOR SEWAGE WORKS OR SECTION 41-2.01 OF THE STANDARD SPECIFICATION FOR WATER AND SEWER MAIN CONSTRUCTION IN ILLINOIS, LATEST EDITION.
- THE CONTRACTOR WILL COORDINATE ANY INTERRUPTION OF ANY SERVICE LINE WITH CITY AND CUSTOMER TO LIMIT OUTAGE TO THE CUSTOMERS.
- THE CONTRACTOR WILL COORDINATE ANY INTERRUPTION OF BUILDING UNIT OWNERS ACCESS WITH THEIR BUILDING UNIT WITH THAT RESPECTIVE BUILDING UNIT OWNER PRIOR TO CONSTRUCTION AND INSTALLATION OF THE SANITARY SEWER LATERALS.
- UTILITY LOCATIONS AND ELEVATIONS ARE APPROXIMATE. IT IS THE CONTRACTOR RESPONSIBILITY TO FIELD VERIFY ALL UTILITIES.
- ALL TRENCHES UNDER AREAS TO BE PAVED AND UNDER EXISTING PAVING SHALL BE FULL HEIGHT GRANULARLY FILLED WITH COMPACTED SELECT GRANULAR BACKFILL, AND THE SURFACE SHALL BE RESTORED WITH FULL DEPTH PAVEMENT REPLACEMENT TO MATCH EXISTING PAVEMENT SECTION/THICKNESS. BACKFILL AND PAVEMENT SHALL BE PLACED IN ACCORDANCE WITH THE CONSTRUCTION STANDARDS AND SPECIFICATIONS OF ALL LOCAL GOVERNING AGENCIES' SPECIFICATIONS AND AS DIRECTED ON THE PLANS.
- EXISTING ABOVE AND BELOW GROUND UTILITIES TO BE PROTECTED AND USED IN PLACE, UNLESS OTHERWISE SPECIFIED. EXISTING UTILITIES AND/OR STRUCTURES AFFECTED BY CONSTRUCTION, EITHER SHOWN OR NOT SHOWN ON THE PLANS, SHALL BE ADJUSTED TO GRADE.
- ABANDONED UNDERGROUND UTILITIES THAT CONFLICT WITH CONSTRUCTION SHALL BE DISPOSED OF OUTSIDE THE LIMITS OF CONSTRUCTION AND AS DIRECTED BY THE ENGINEER. THIS WORK WILL NOT BE PAID FOR SEPARATELY, BUT SHALL BE CONSIDERED INCIDENTAL TO THE CONTRACT.

NO.	DATE	DESCRIPTION
DATE: 03-13-2024		
PROJECT NO: 280-0454		
DESIGN: ZAY	DRAWN: JMA	CHECK: SMS

SITE PLAN

C-103

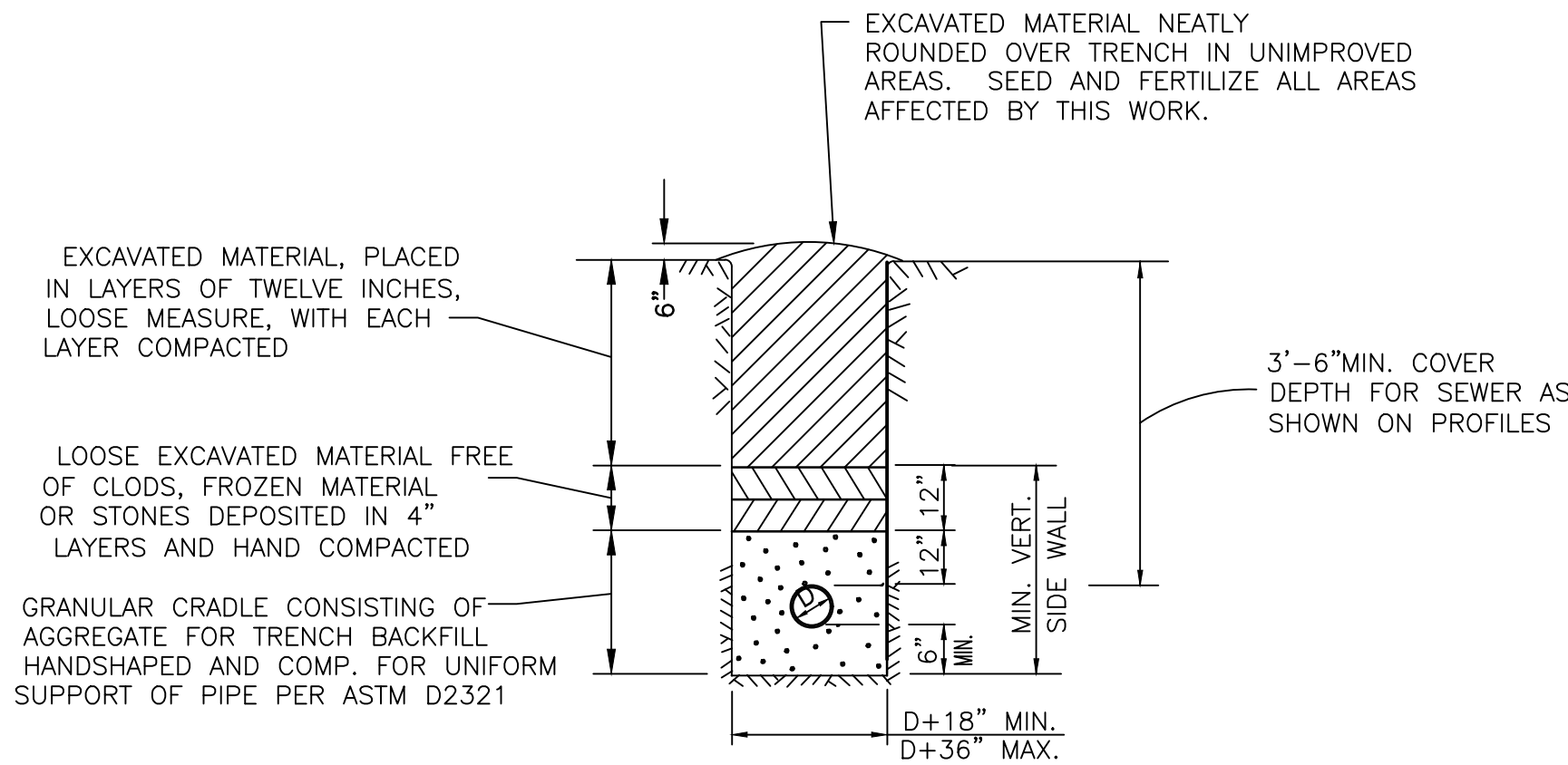

TRENCH DETAIL UNIMPROVED AREA
NOT TO SCALE

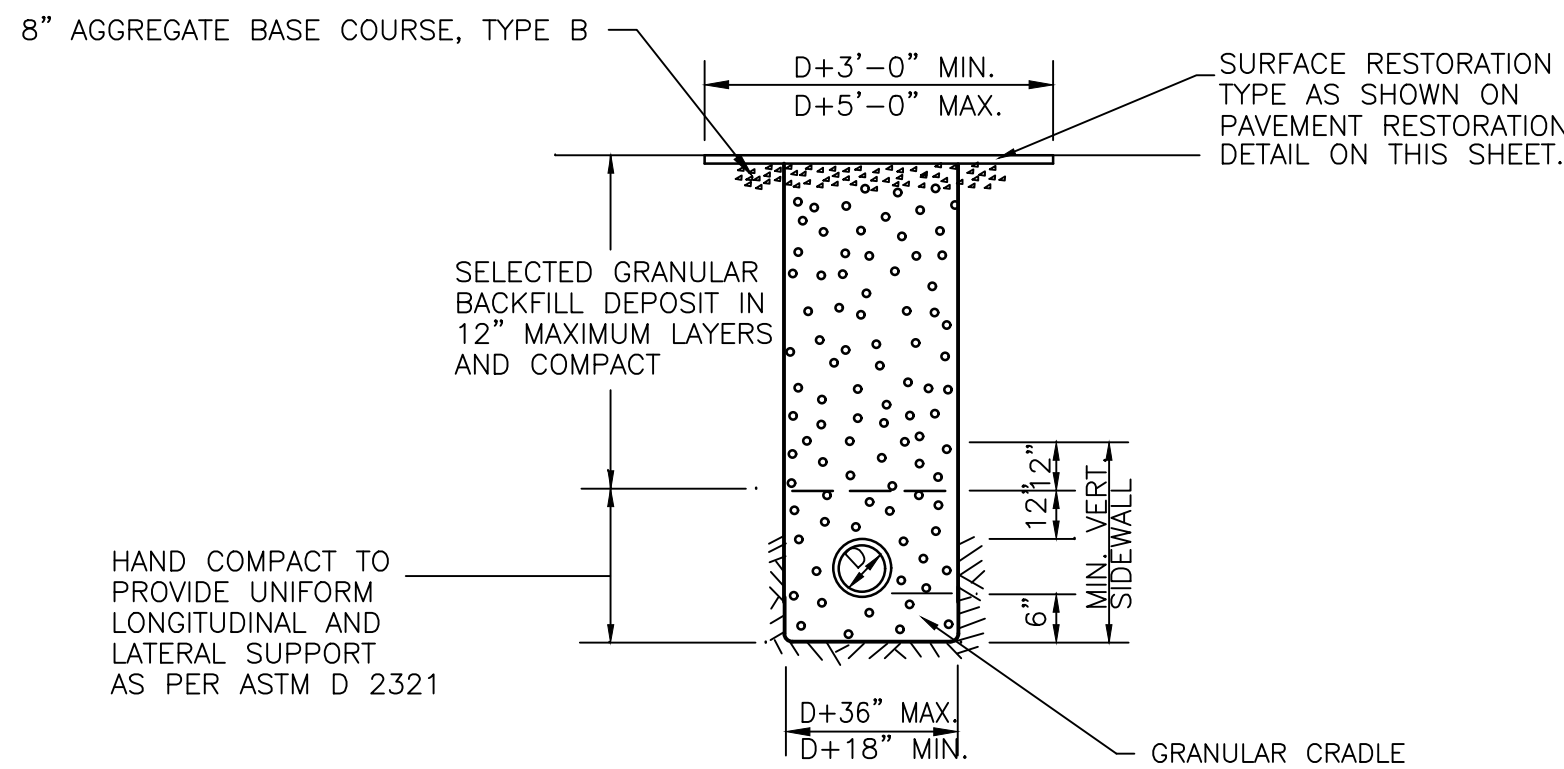

TRENCH DETAIL IMPROVED AREA
NOT TO SCALE

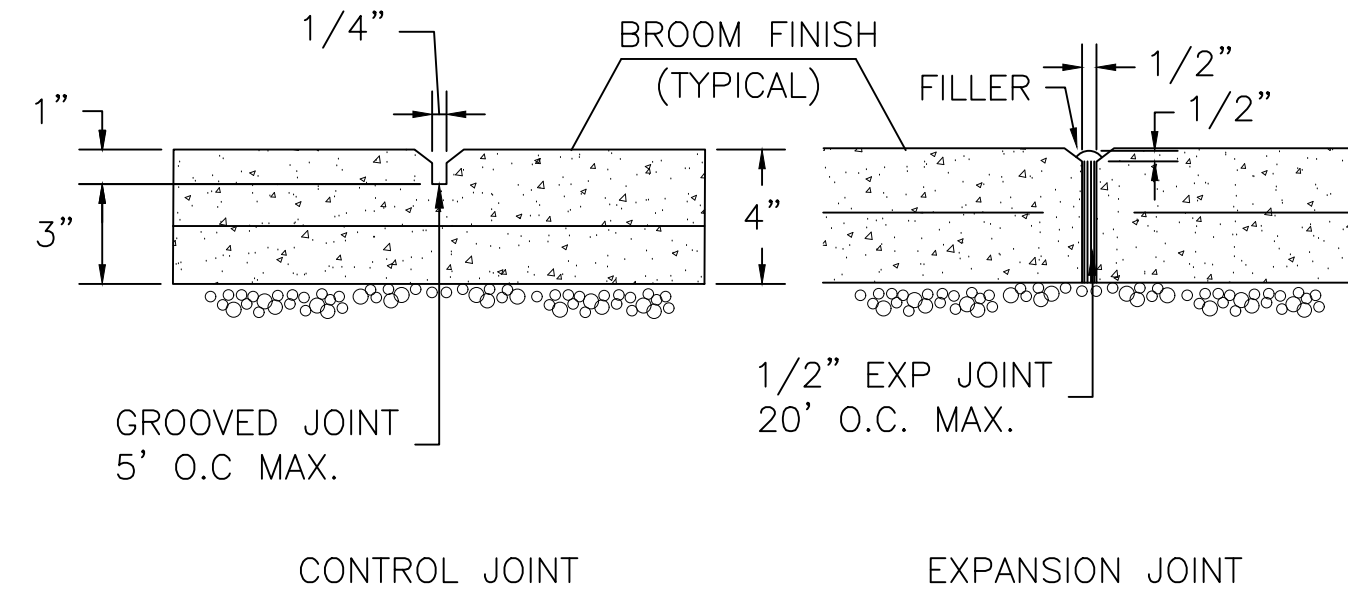

TYPICAL SIDEWALK JOINTS
NOT TO SCALE

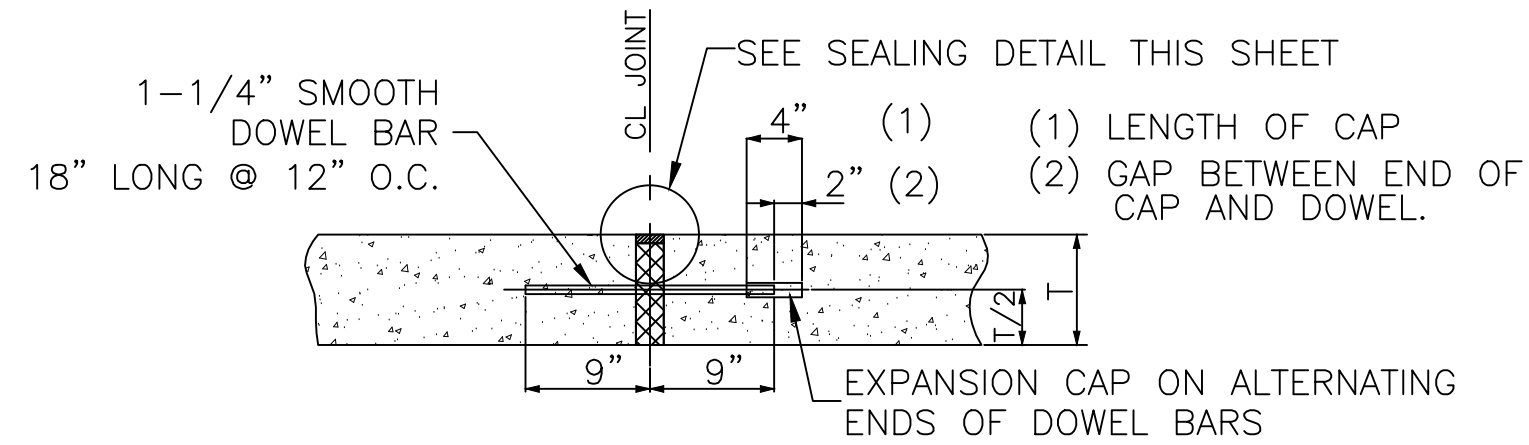

EXPANSION JOINT
NOT TO SCALE

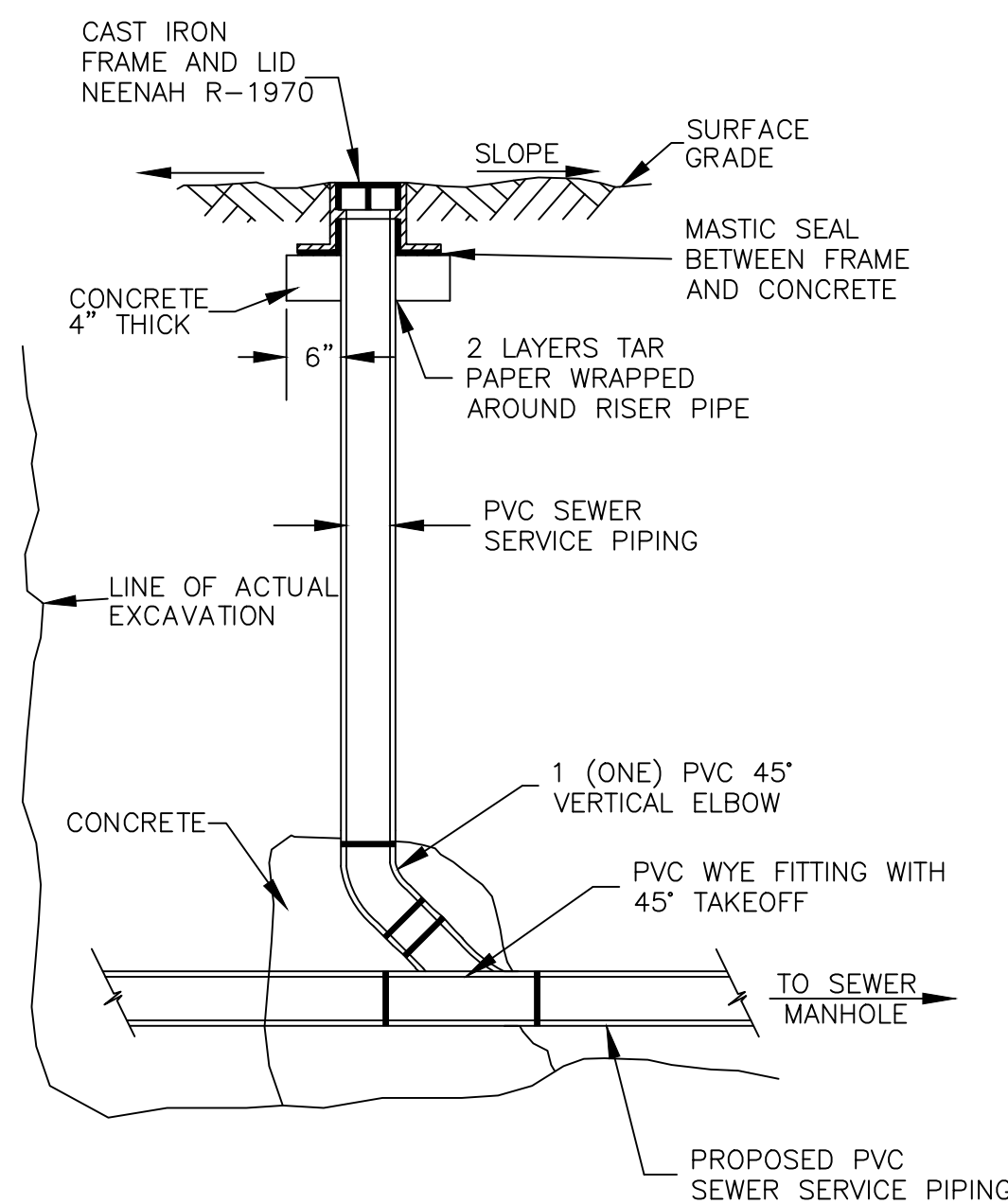

CLEANOUT DETAIL
NOT TO SCALE

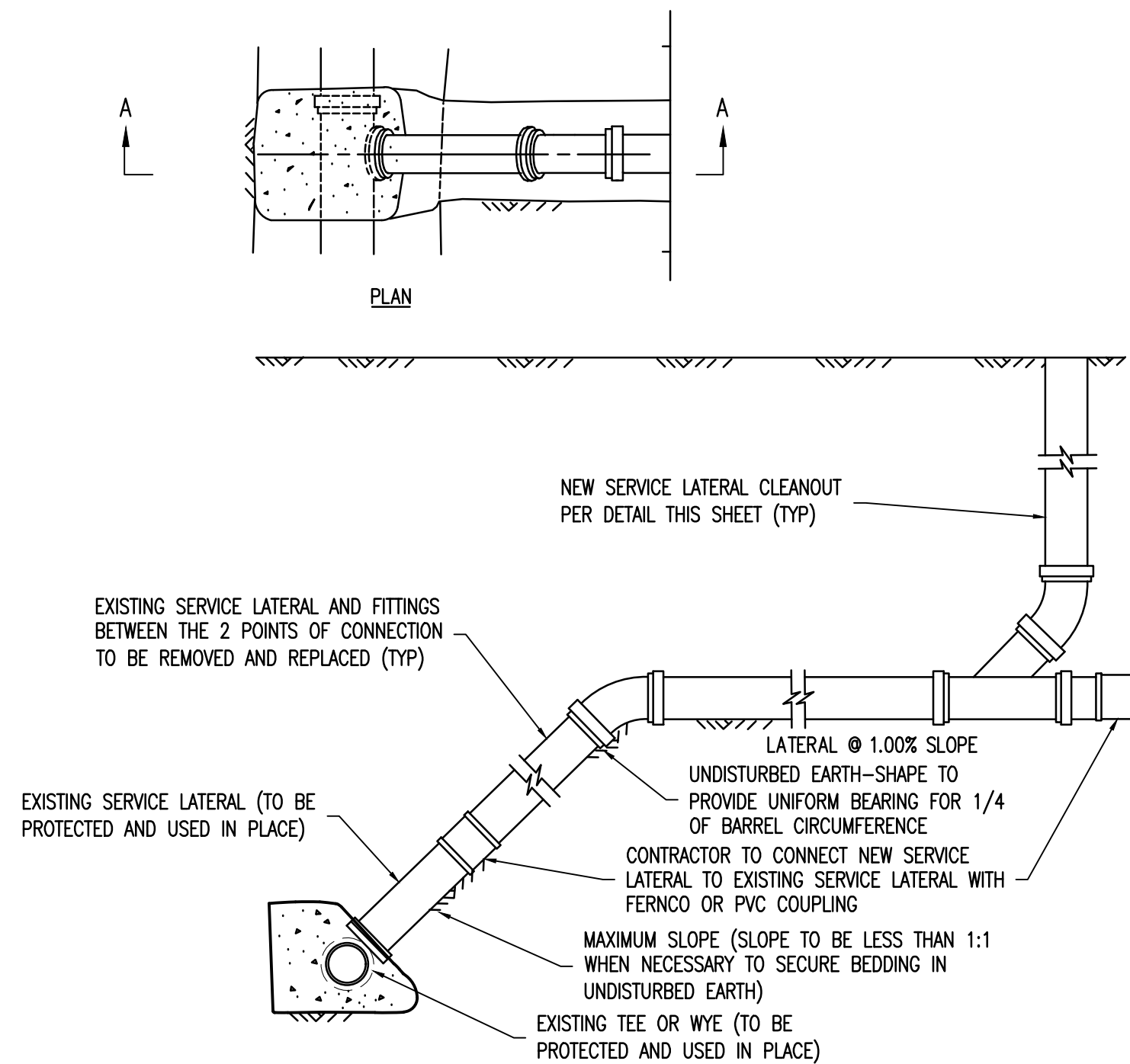

TYPICAL SERVICE LATERAL REMOVAL AND REPLACEMENT DETAIL
NOT TO SCALE

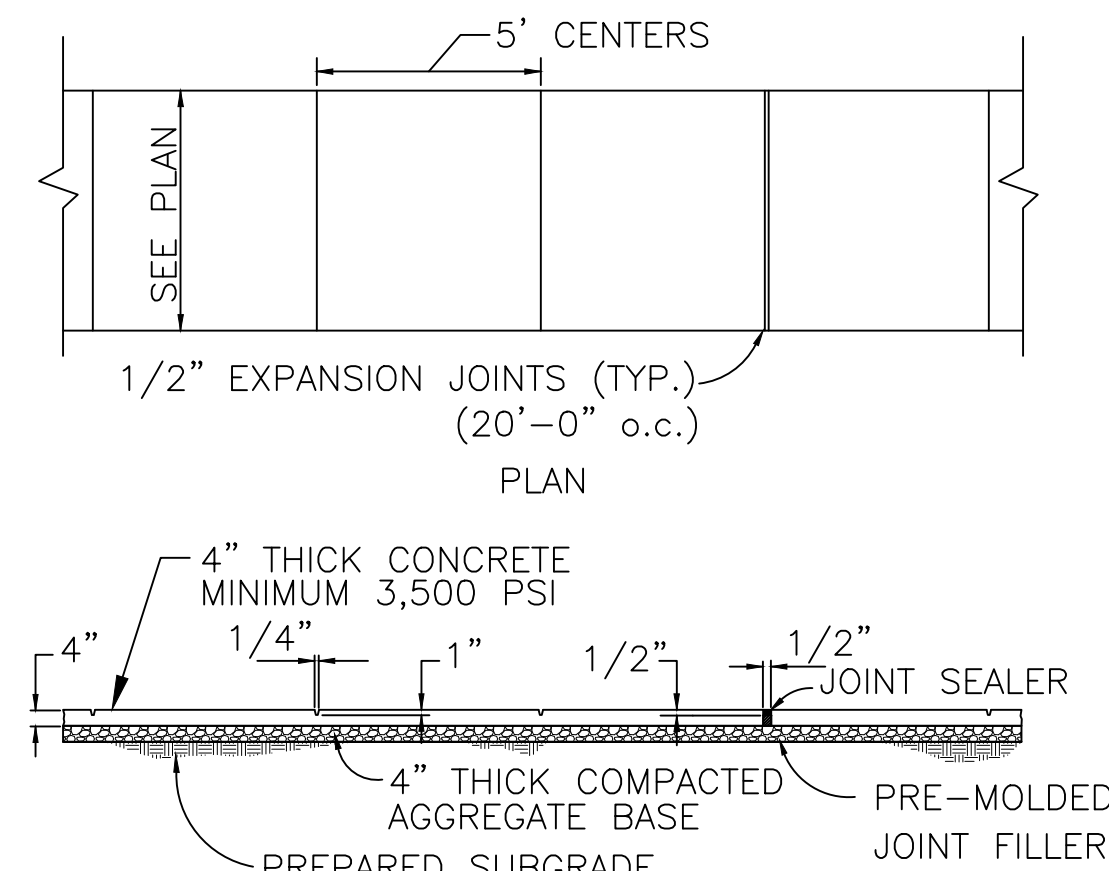

CONCRETE SIDEWALK DETAIL
NOT TO SCALE

MK.	DATE	DESCRIPTION

DATE: 03-13-2024
PROJECT NO: 280-0454
DESIGN: ZAY DRAWN: JMA CHECK: SMS

MISCELLANEOUS
DETAILS